



E-STILTS
Simple & ingenious





I N T R O D U C T I O N

Inspired by stilts house – a pile dwelling that come with raised structure, and normally built over sand or above water, “E-Stilts” is created as our new leg. As found in Wikipedia, “Stilts” are pillars or posts to allow a structure to stand at a height above the ground, “E-Stilts” has come up to act as a desking system. Stilts house which is easy to construct and protect against nature elements of flood and earthquake applies to E-Stilts understructure. It act as a pile driver of strength on its foundation.

E-Stilts act as a simple, ingenious, and adaptive bench, for entire range of application in open workplace. It is a reconfigurable bench and suitable for any demands of office environment. On this basis, E-Stilts is offering a great flexibility to work across a wide range of configuration demands, from staff workstation to manager workstation and conference table.



T A B L E O F CONTENTS

03 - 05	Linear Workstation
06	L-Shaped Workstation
07 - 08	120 Degree Workstation
09 - 10	Executive Work Desk
11 - 13	Conference Table
14	Discussion table
15	Bar Table
16	Waiting Area
17 - 18	Wire Management
19	Flexible & Efficiency Reconfiguration Understructure
20	Details
21	Options
22	Certificates
23 - 24	Project References
25 - 26	Major Contracts



LINEAR WORKSTATION

E-Stills bench design allows 2 or more people to work together without losing their personal space. It integrated personalized work tools and storages on table tops, allow individuals to access it easily.

Worktop Colour : American White Ash

Cabinet Colour : American White Ash

Epoxy Colour : White

Privacy Panel : Morton 9338 Summer Lime

Chair Model : Xenic

Dimension:

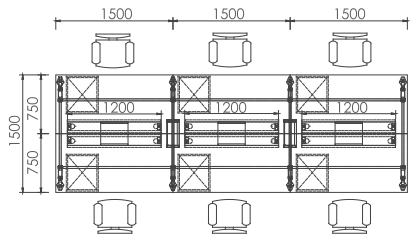



LINEAR WORKSTATION

Teams need places that allow them to see their teammates comfortably, hear each other clearly and share information easily in order to build social capital and the "shared mind" that is necessary to bring innovation to successful conclusion. E-Stilts design offers a comfortable place to work, focus and maximise interaction between each other.

Worktop Colour : American White Ash

Cabinet Colour : American White Ash

Epoxy Colour : White

Privacy Panel : Frosted Glass

Chair Model : Xera

Dimension:

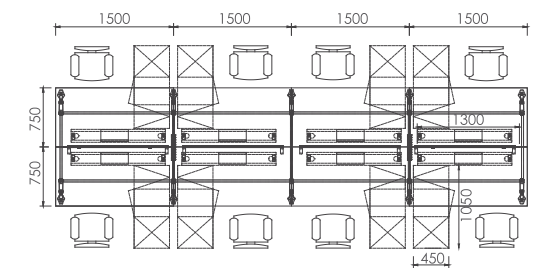

LINEAR WORKSTATION

A minimalistic and simple office helps people to concentrate and clear their minds. E-Stillts designed with minimal components to provide more leg movement spaces. It completes with TrendX Pro hanging fabric panel that not only acts as privacy screen but also as modesty panel.

Worktop Colour : Marinus Walnut

Cabinet Colour : Marinus Walnut & White

Epoxy Colour : White

Privacy Panel : Platinum P16 Laguna

Chair Model : Xenic

Dimension:

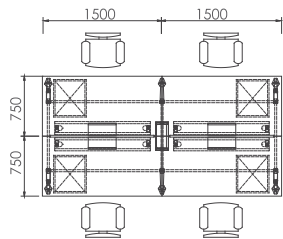



L-SHAPED WORKSTATION

Versatile working scenarios with add-on table for additional surface space and storage unit as storage space for documents with modern style and simple modularity that delivers on form and functions.

Worktop Colour : Rochelle White

Cabinet Colour : Rochelle White

Epoxy Colour : White

Privacy Panel : Morton 9585 Citrus Orange

Chair Model : Xenic

Dimension:

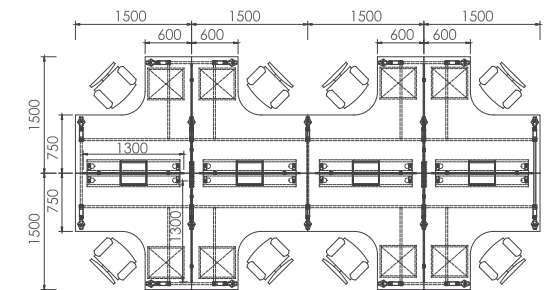

120 DEGREE WORKSTATION

E-Stilts 120 degree planning design system can create higher workstation densities to optimise office layout, that help employees engage and amplify the performance of people, teams and organizations.

Worktop Colour : Murnau Maple

Epoxy Colour : White

Privacy Panel : BZ46 Orange

Chair Model : Xenic

Dimension:

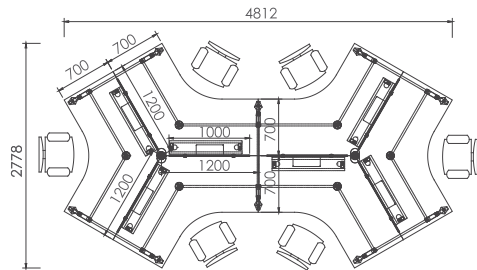



120 DEGREE *WORKSTATION*

E-Stills 120 degree workstation creates informal and sociable feel in workplace, provides greater amount of workspace, storage and collaboration working environment. It also creates a comfortable working environment in which the tools we need are always within reach.

Worktop Colour : Snow White

Epoxy Colour : Champagne

Privacy Panel : Morton 9440 Cloud Dancer

Chair Model : Xera

Dimension:

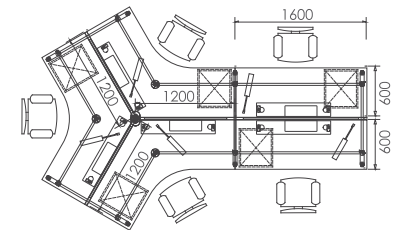

EXECUTIVE WORK DESK

E-Stillts combines the sophisticated quality of refined design and fine wood craftsmanship with the convenient integration of electrical technologies. Its bring styles and sophistication to modern office.

Worktop Colour : American White Ash

Cabinet Colour : American White Ash

Epoxy Colour : White

Chair Model : Xenic

Dimension:

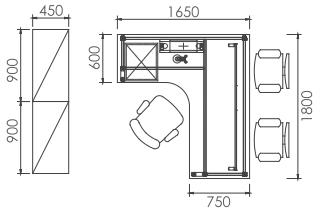



EXECUTIVE *WORK DESK*

E-Stills was designed with storages design creates individual working space and space saving functionality for executive to work harder and smarter. It provides a range of applications to support collaborative and individual work.

Worktop Colour : Marinus Walnut

Cabinet Colour : Marinus Walnut

Epoxy Colour : White

Chair Model : Bueno

Dimension:

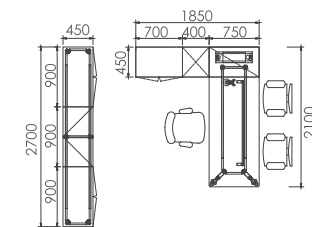

CONFERENCE TABLE

E-Stillts is designed for all level of communication and management tasks, equipped with the center wire riser box, all power and data cables are integrated into the central of table and neatly kept. The intelligent design of wire riser box also minimize the number of table legs and optimize user comfort.

Worktop Colour : American White Ash

Epoxy Colour : White

Chair Model : Supremo

Dimension:

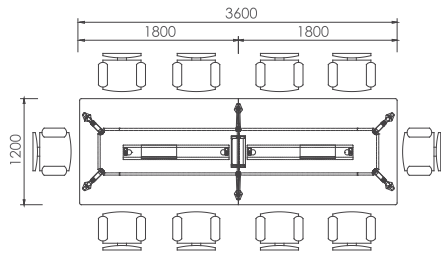



CONFERENCE TABLE

E-Stilts rectangular meeting table reflects simplicity and elegance in large meeting room. The smart designed electrification and cable management solution make E-Stilts act as a highly flexible system which can be easily reconfigured and with ample room for legs movement.

Worktop Colour : Marinus Walnut

Epoxy Colour : Black

Chair Model : Bueno

Dimension:

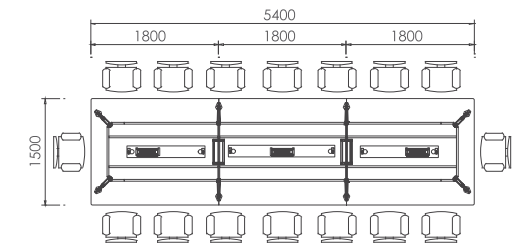

CONFERENCE TABLE

E-Stillts boat shaped conference table presents modern yet contemporary concept. Its curve edges design can accommodate larger crowd yet make the room look spacious, perfectly for professional meetings in a conference room. The table comes with easy data access and power supply connection application to allow people comfortably with their electrical assets.

Worktop Colour : Havana Oak

Epoxy Colour : White

Chair Model : Supremo

Dimension:

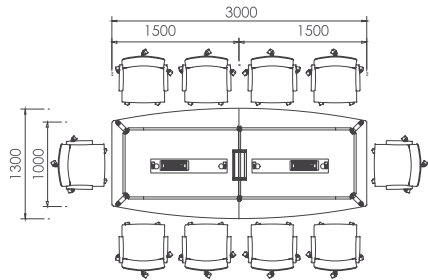



DISCUSSION TABLE

E-Stills discussion table suits for office group discussion or staff café. It is complemented with wooden top or glass top with various table shapes and numerous table top colours, to ensure a unique and great impression look.

Worktop Colour : Glass & Marinus Walnut

Epoxy Colour : Light Grey

Chair Model : Supremo

Dimension:

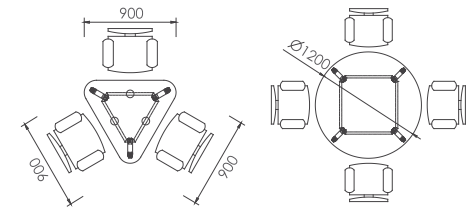

BAR TABLE

E-Stills creates ecosystem with palette of posture-spaces that encourage people to sit, discuss, stand and move through their day, while supporting the different kinds of work they do.

Worktop Colour : Olive Ash

Epoxy Colour : White

Chair Model : Stool

Dimension:

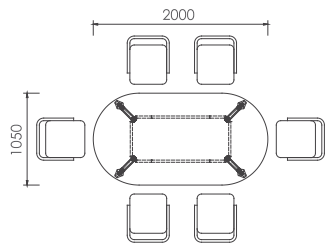



WAITING AREA

E-Stilts bench was created to solve the challenges of today's waiting places. A modular system that can be reconfigured in many ways for many applications.

Epoxy Colour : White

Seating : Vertex 1818-23 Martique

Dimension:

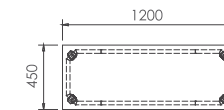
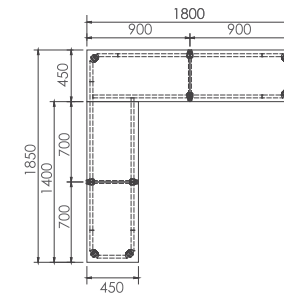

WIRE MANAGEMENT

Intelligent designed wire management solution makes E-Stilts neat and easy to route power and data up to workspace.



Aluminium wire tray drives wires underneath the desk and uses metal wire riser box for storing massive wires, creates effective wire management solutions in workplace.



There is an optional way to route wires to table top, via E-Stilts table leg. This is ideal for executive workstation whose wire is small in capacity.

WIRE TRAY



Single metal wire tray

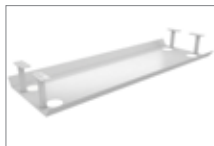

Double metal wire tray



Single basket wire tray



Single aluminium wire tray

FLIP UP DOOR



Aluminium flip up door with press button



Aluminium flip up door with press button & soft close mechanism

WIRE RISER



Metal wire riser box (Small)
L210 x D160 x H719



Metal wire riser box (Medium)
L340 x D160 x H719



Metal wire riser box (Large)
L490 x D160 x H719



I-Beam aluminium wire riser (attach to top)



I-Beam aluminium wire riser (attach to table beam)



Metal wire riser (attach to top)



Metal wire riser (attach to table leg)



Wire conduit

FLEXIBLE & EFFICIENCY RECONFIGURATION UNDERSTRUCTURE

ONE SIZE DOESN'T FIT ALL

In table top extension, E-Stilts can be extended in length of L150 and L300. This table top extension function normally is applicable for conference table.

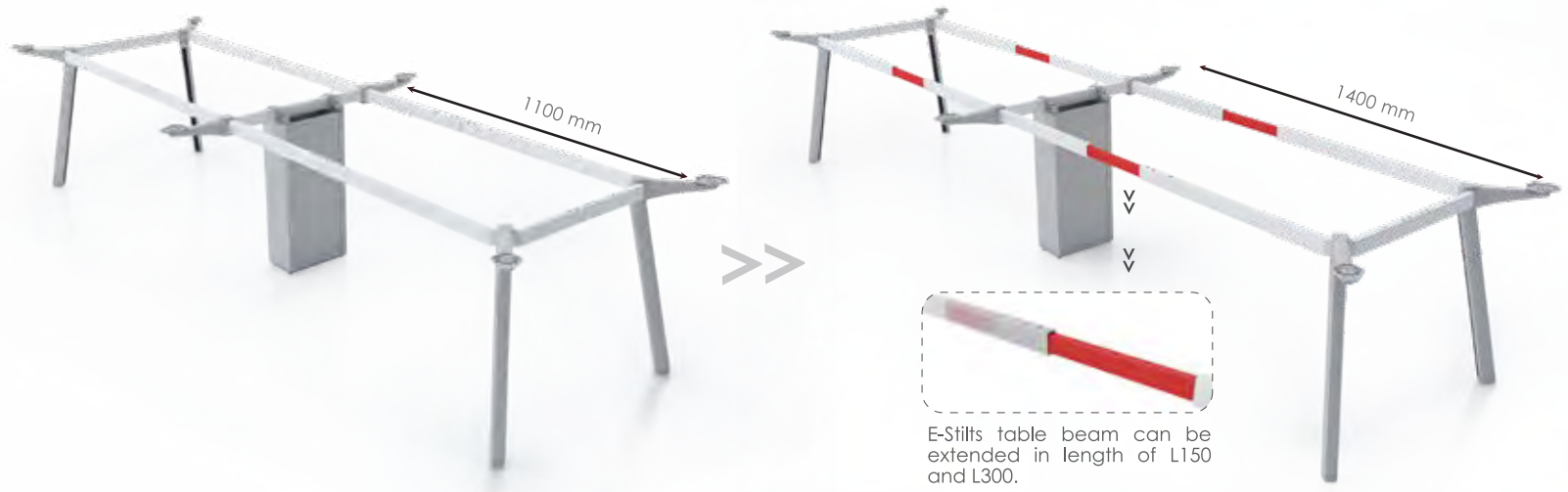

PRACTICE SOLUTION TO CATER MANY DIFFERENT NEEDS AND BEHAVIORS

Add-on table without removing the existing table top. This table extension function normally is applicable for staff workstation in linear and L-shaped.

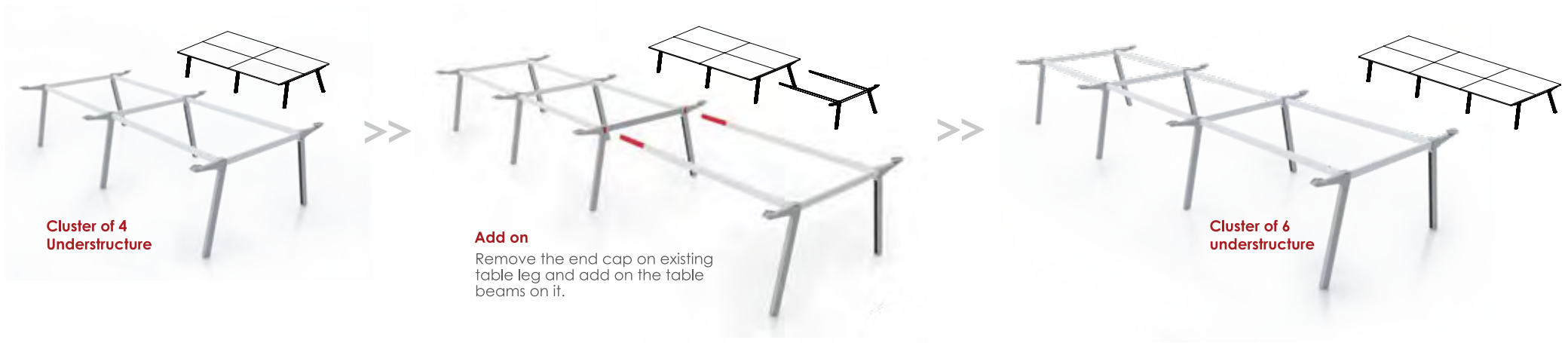

DETAILS

LEG PROFILE



Slant leg with table arm

Straight leg with table arm

Slant and straight leg with table arm

Slant leg

Straight leg

Slant and straight leg

LEVELER



Manual regulation leg that can be adjusted by just using a screwdriver.

ADJUSTABLE LEG



E-Stilts system also act as height adjustable table to allow people to adjust the height for table up to 150 mm.

LEG ANGLES



45 Degree

90 Degree

TABLE ARM

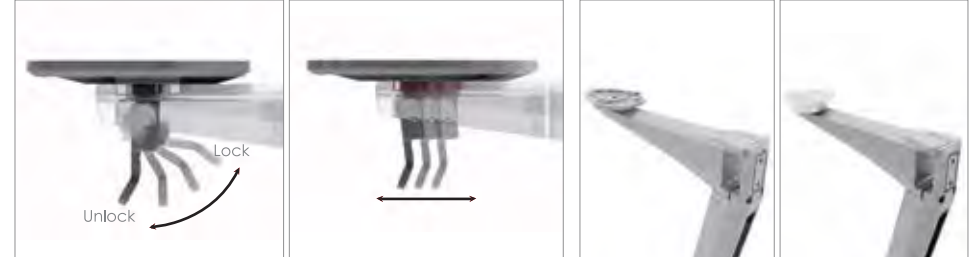

E-Stilts table arm come with locking mechanism, to attach to table top without bolts and nuts with approximately 10 mm of free movement. This table arm also can be applied in Trendx Pro System.

Table arm for wooden top

Table arm for glass top

OPTIONS

TRENDX PRO PANEL



- TrendX Pro panel is a 22 mm thick panel with aluminium frame.
- It hangs on the table top as privacy screen, creating a minimal boundary while keeping the space open.
- Panel upholstery options: fabric, pinnable fabric, glass, whiteboard, magnetic whiteboard, polycarbonate and accessories rail.

I-BEAM PANEL



- I-Beam screen is a groove edge designed 18 mm thickness screen.
- I-Beam panel upholstery options: fabric, pinnable fabric, glass, whiteboard, glass whiteboard, polycarbonate and accessories rail.

IF PANEL

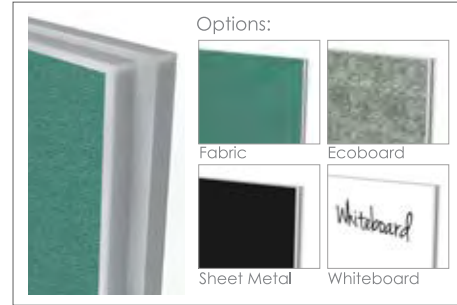

- IF panel is a slim 18 mm panel with frameless design.
- IF panel upholstery options: fabric, ecoboard, sheet metal and whiteboard.

MODESTY PANEL



- A modesty panel is designed to conceal one's legs when seated and possess beauty.
- It is available in a range of different sizes, depending on the table shape, size and the extent of concealment required.
- Modesty panel options: netting, metal perforated, frosted glass and wooden.

ACOUSTIC PAD

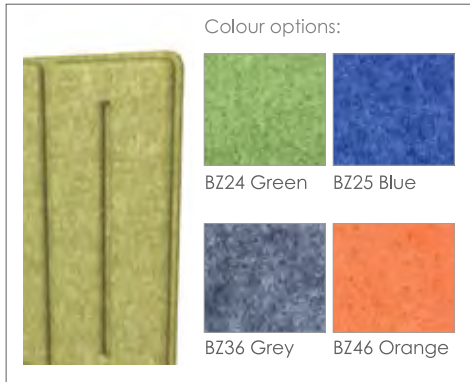

- A 20 mm thick acoustic pad, available in 4 colour options: green, blue, grey and orange.
- Standard dimension: H340 (L450 - L1800)
- The panel length can be reduced or extended with limitation of 150 mm each time.
- Its ideal lengths are 1800 mm & 900 mm, price will be charged according to these measurements regardless of customized length.

GLASS DIVIDER SCREEN



Clear Glass Screen Frosted Glass Screen

- A 8 mm thickness laminated glass screen, available in clear or frosted glass.

PANEL TRACK



For Fabric Divider Screen For IF Screen

- Panel track that provide panel mounting options.

SLIDE-ON DIVIDER SCREEN



- Slide-on divider screen is a 22 mm thick fabric screen with translucent PVC lining.

- It attaches to the worktop to provide lateral space division to create individual work areas.

- The screen can be personalized through a range of fabric options.



Slide-on Divider Screen Bracket

WORKSURFACE



- Available material options: Melamine Faced Chipboard (MFC) and High Pressure Laminate (HPL).

- Available worksurface edging options: flat and reverse chamfered.



Flat

Reverse chamfered

EPOXY COLOUR

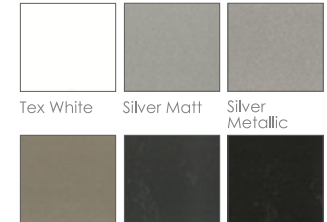

- All of the leg structures and panel frames are come with epoxy coating to protect the stucture from rusty and give it to a clear and glossy look.

- Epoxy colour options: tex white, silver matt, silver metallic, champagne, graphite and black.

Disclaimer: 1. All images are for illustration purposes only.
2. Colour shown may not be an accurate representation of the actual colour, please refer to actual colour samples for final confirmation.

CERTIFICATES

Test Certificate

TEST CERTIFICATE

This Certificate is issued to:
ARTMATRIX TECHNOLOGY SDN BHD
 LOT 32789, JALAN S1/A,
 TAMAN PERINDUSTRIAN SELESA JAYA,
 43300 BUKIT SERI,
 SELANGOR, MALAYSIA

FOR
 Product: **PAMEL DESKING SYSTEM**
 Brand/Model: **E-STILTS**
 Detail:
 Specification: **ANSI/BIFMA X5.9-2014 – DESK/TABLE PRODUCTS – TESTS**
 Test Report No: **12000008**
 Date of Test Report Issued: **JULY 14, 2020**

SUMMARY:
 A sample of the product has been tested and is found to meet with the requirement of the above specification.

GreenTech
 Quantium Independent Certification Pte Ltd
 Certificate No: 107000088 Date of Original Issue: JULY 14, 2020 Date of Last Revision: Date of Expiry: JULY 13, 2022

This Certificate is valid for a period of 24 months from the date of issue. The validity of the certificate is subject to the terms and conditions of the Test Certificate Scheme.
 Note: This certificate is issued pursuant to the test report and issued.

Singapore Green Building Product Certificate

SINGAPORE GREEN BUILDING COUNCIL

SINGAPORE GREEN BUILDING PRODUCT CERTIFICATE

ISSUED TO:
Artmatrix Technology Sdn Bhd
 Lot 32789, Jalan S1/A,
 Taman Perindustrian Selesa Jaya,
 43300 Bukit Serai,
 Selangor, Malaysia

FOR THE PRODUCT:
Modular Furniture

PRODUCT BRAND:
Artmatrix

PRODUCT MODEL:
E-STILTS (ECO)

THE PRODUCT HAS BEEN ASSIGNED ACCORDING TO THE ASSASSMENT CRITERIA OF THE SINGAPORE GREEN BUILDING PRODUCT CERTIFICATION SCHEME. IT HAS BEEN AWARDED THE FOLLOWING:

SINGAPORE GREEN BUILDING PRODUCT SGBC EXCELLENCE

GreenTech
 Quantium Independent Certification Pte Ltd
 Certificate Number: 107000088 Original Issue Date: 24 June 2022 Revised Date: 01 October 2022 Valid To: 23 June 2024

This certificate is valid for a period of 24 months from the date of issue. The validity of the certificate is subject to the terms and conditions of the Singapore Green Building Product Certification Scheme. Revised products may also be issued at the discretion of the Council. This certificate status may be verified at the Singapore Green Building Council website (www.sgbc.sg)

GECA Certificate

GECA Good Environmental Choice Australia Licence

GECA (Good Environmental Choice Australia) manages a Type 1 EcoLabel program in accordance to ISO 14024 'Environmental Labels and Certifications' and is the owner of the Good Environmental Choice Australia EcoLabel.

The following products and/or services have been granted the use of the ecoLabel and have been verified by an independent conformity assessment body that they meet the environmental, health and social/ethical criteria of the GECA standard.

License number: 001-001
Issued for: ARTMATRIX TECHNOLOGY SDN BHD
Issue date: 14 January 2021
License valid until: 13 June 2022

Certified products:
 PAMEL (ECO) Desking System PAMEL (ECO) Desking System
 PAMEL (ECO) Modular Furniture PAMEL (ECO) Desking System
 PAMEL (ECO) Modular Furniture PAMEL (ECO) Desking System
 PAMEL (ECO) Modular Furniture PAMEL (ECO) Desking System
 PAMEL (ECO) Modular Furniture PAMEL (ECO) Desking System

GreenTech
 Quantium Independent Certification Pte Ltd
 Certificate Number: 107000088 Original Issue Date: 24 June 2022 Revised Date: 01 October 2022 Valid To: 23 June 2024

GECA CERTIFIED

MyHijau Certificate

MyHIJAU · MARK

ARTMATRIX TECHNOLOGY SDN BHD
 Lot 32789
 Jalan S1/A, Taman Perindustrian Selesa Jaya
 43300 Bukit Serai
 Selangor

This is to certify that

ARTMATRIX TECHNOLOGY SDN BHD has the rights to use the MyHIJAU Mark on the following item:
 (Refer to Schedule Page for more details)

Compliance Category:
 Green Label Certification (SG 14024 Type | ECO-Label)

Certification Scheme:
 Environmental Choice Australia EcoLabel

GreenTech
 Quantium Independent Certification Pte Ltd
 Certificate No.: MyHP0008015
 Issue Date: 24-07-2021
 Expiry Date: 23-06-2024

GECA CERTIFIED

E-STILTS (ECO) Desking System
 Cert. No : MyHP0008015-8002

PROJECT REFERENCES



UBER MALAYSIA SDN BHD



UBER MALAYSIA SDN BHD



UBER MALAYSIA SDN BHD



UBER MALAYSIA SDN BHD



UBER MALAYSIA SDN BHD



UBER MALAYSIA SDN BHD



BOEING ASIA PACIFIC AVIATION SERVICES PTE LTD, SINGAPORE



BOEING ASIA PACIFIC AVIATION SERVICES PTE LTD, SINGAPORE

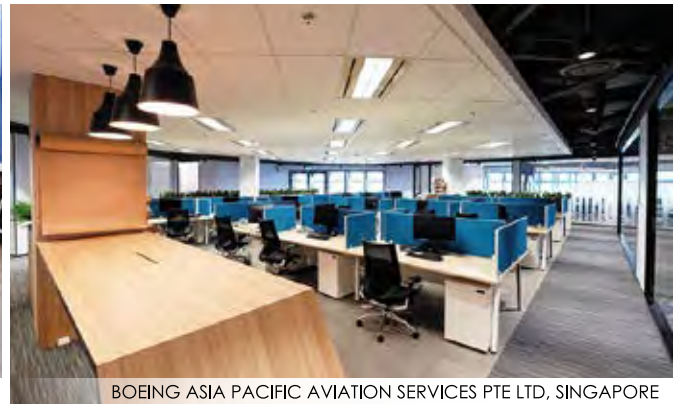

BOEING ASIA PACIFIC AVIATION SERVICES PTE LTD, SINGAPORE



UNIVERSITY OF READING MALAYSIA

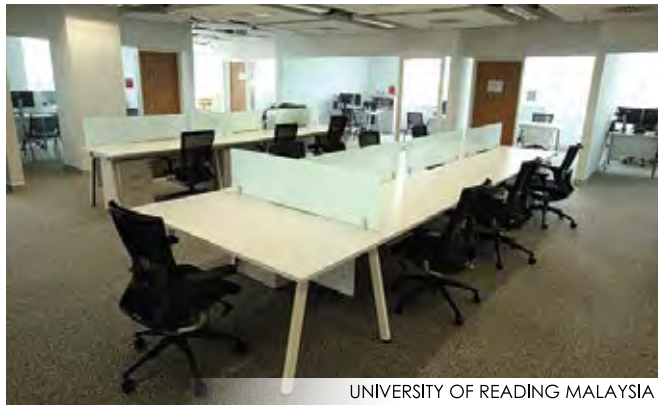

UNIVERSITY OF READING MALAYSIA



UNIVERSITY OF READING MALAYSIA

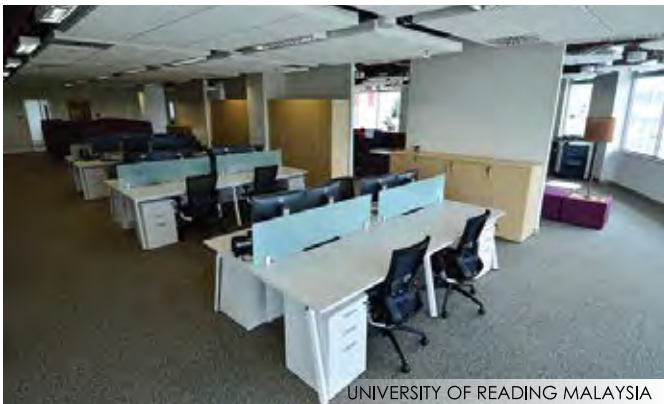

UNIVERSITY OF READING MALAYSIA



UNIVERSITY OF READING MALAYSIA

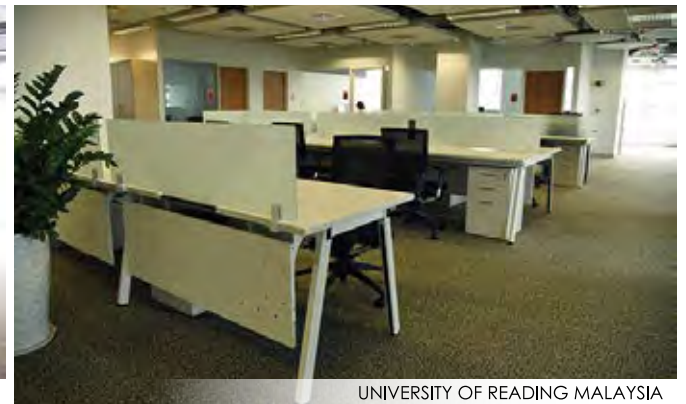

UNIVERSITY OF READING MALAYSIA



LF LOGISTIC (S) LIMITED, SINGAPORE



LF LOGISTIC (S) LIMITED, SINGAPORE

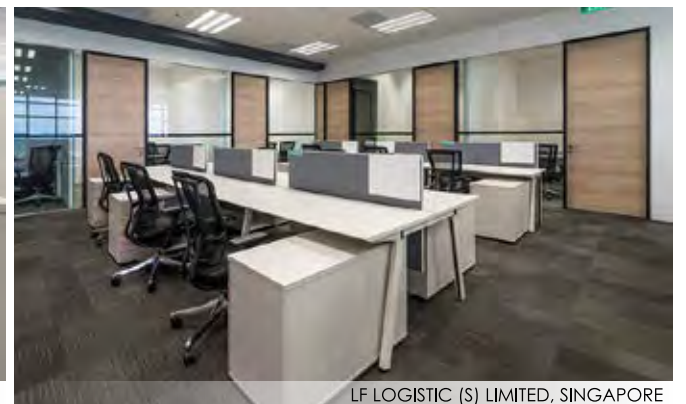

LF LOGISTIC (S) LIMITED, SINGAPORE

MAJOR CONTRACTS

MALAYSIA

2022

RM 7.7 Mil	United Overseas Bank (M) Berhad, Plaza 2, Kuala Lumpur
RM 3.8 Mil	Bursa Malaysia Berhad
RM 3.5 Mil	Kastam
RM 2.1 Mil	MyIPO
RM 1.1 Mil	Ambank (M) Berhad
RM 1.0 Mil	AIA Bhd
RM 1.3 Mil	United Overseas Bank (M) Berhad, 1 Power House, Petaling Jaya
RM 4.1 Mil	TM Hijrah
RM 1.05 Mil	Unit Peneraju Agenda Bumiputera (TERAJU)
RM 0.7 Mil	Pengurusan Aset Air Berhad
RM 0.65 Mil	Menara TS Law
RM 0.72 Mil	PERKESO, Klang
RM 0.6 Mil	BP Business Service Centre Asia Sdn Bhd
RM 0.52 Mil	Maybank, Mercu Maybank I City

2021

RM 1.2 Mil	TNB Genco
RM 18.6 Mil	KWSP Kwasa
RM 1.1 Mil	Lembaga Air Perak

2020

RM 2.9 Mil	Pengurusan Air Selangor Sdn Bhd - Bangsar Trade Centre
RM 2.6 Mil	MBSB Bank Berhad (HQ)

2019

RM 2.6 Mil	Standard Chartered Bank, Equatorial Plaza KL
RM 1.9 Mil	Sime Darby Motors City - Ara Damansara

2018

RM 5.4 Mil	Cybersecurity
RM 1.2 Mil	MCIS insurance Berhad

RM 4.0 Mil	CIMB Bank Berhad, Wisma CIMB, Menara CIMB, MBC
RM 1.7 Mil	Cyberjaya University College of Medical Science
RM 2.8 Mil	Public Mutual Berhad
RM 1.5 Mil	Ambank (M) Berhad
RM 1.3 Mil	Sime Darby Holdings Bhd, Malaysia

2017

RM 3.2 Mil	Pusat Pentadbiran Negeri Sabah
RM 7.0 Mil	National Institute of Health - Ministry of Health Malaysia Setia Alam

2016

RM 1.5 Mil	Perbadanan Kemajuan Negeri Selangor (PKNS)
RM 1.3 Mil	BAT ASPAC Service Centre Sdn Bhd
RM 3.2 Mil	MISC Berhad - Menara Dayabumi KL

2015

RM 3.0 Mil	University of Reading Malaysia
RM 2.0 Mil	Perbadanan Tabung Pendidikan Tinggi Nasional (PTPTN)
RM 1.7 Mil	AIA Bhd

2014

RM 1.6 Mil	Carigali Hess Operating Company Sdn Bhd - Menara Darussalam KL
RM 2.9 Mil	SME Bank HQ

2013

RM 2.4 Mil	Petronas Carigali EROC - Menara Binjai KL
RM 1.1 Mil	Deloitte Malaysia - Menara LGB

2013

RM 2.4 Mil	Petronas Carigali EROC - Menara Binjai KL
RM 1.1 Mil	Deloitte Malaysia - Menara LGB

2012

RM 1.9 Mil Huawei Technologies (Malaysia) Sdn Bhd - The ICON KL
RM 1.7 Mil Petrofac Malaysia - Tower 3 KLCC

2011

RM 1.6 Mil Alliance Bank Malaysia Berhad - Capital Square KL

2010

RM 20.0 Mil Putrajaya Holdings Sdn Bhd (Parcel 5G2, 4G8, 4G9, 4G10)
RM 5.5 Mil University Malaysia Sabah (UMS)

2009

RM 7.0 Mil CIMB Bank Berhad, Menara MBC KL

SINGAPORE

2022

RM 1.2 Mil VCOP MICRON

INDIA

2017

RM 1.7 Mil Renault Nissan, India

2016

RM 4.0 Mil TCS (Tata Consultancy Services), India
RM 4.0 Mil CTS (Cognizant Technology Solutions)
Block Teak G3, India

2015

RM 8.0 Mil TCS (Tata Consultancy Services), India

2014

RM 5.8 Mil TCS (Tata Consultancy Services), India
RM 2.1 Mil CTS (Cognizant Technology Solutions), India

2013

RM 4.8 Mil CTS (Cognizant Technology Solutions), India
RM 3.3 Mil TCS (Tata Consultancy Services), India

2012

RM 16.0 Mil TCS (Tata Consultancy Services), India ~Phase II

2011

RM 16.0 Mil CTS (Cognizant Technology Solutions), India

2010

RM 19.0 Mil TCS (Tata Consultancy Services), India

THAILAND

2017

RM 2.6 Mil Pearl Bangkok, Thailand

INDONESIA

2018

RM 1.7 Mil PIK Office ASG, Indonesia

2016

RM 6.0 Mil MNC Group, Indonesia



ARTMATRIX TECHNOLOGY SDN BHD 200501017101 (694144-X)
ARTMATRIX MANUFACTURING SDN BHD 200501016616 (693659-U)
 Lot 32789, Jalan 5/1A, Taman Perindustrian Selesa Jaya,
 43300 Balakong, Selangor, Malaysia.
 ☎ +603 8962 2286 📠 +603 8961 8862
 ✉ sales@artmatrix.com.my 🌐 www.artmatrix.com.my

FOLLOW US



MALAYSIA • SINGAPORE • THAILAND • MAURITIUS • INDIA • INDONESIA • PHILIPPINES • CAMBODIA • MYANMAR • SAUDI ARABIA

Accreditation



Green Labels and Awards



International Member of



Member of

